

General Information

Meeting Location & Contact Information

Mandarin Orchard Hotel

333 Orchard Road, Singapore 238867

T: (65) 6737 4411 **F:** (65) 6732 2361 **E:** orchard@meritushotels.com

Mandarin Orchard Singapore is easily accessible. The nearest MRT station is *Somerset*. The hotel is accessible via hotel limousines, taxis, airport shuttle buses, trains and public buses from and to the Airport.

Transport -Taxi

Metered taxis to the hotel are readily available at the Arrival Halls of Singapore Changi Airport. Travelling time from the Airport to the hotel is around 30 minutes. Taxi fare from the Airport is approximately \$25.00 by meter.

Transport - MRT

Train services are available at the Airport train station located at Terminal 2 and Terminal 3. Transfer to the westbound train at *Tanah Merah* train station to alight at *Somerset* train station. The hotel is a 5-minute walk from the station. More information can be found at: <https://www.visitsingapore.com/travel-guide-tips/getting-around/>

Electricity and Plug

Electricity in Singapore is 230 Volts, alternating at 50 cycles per second. If you travel to Singapore with a device that does not accept 230 Volts at 50 Hertz, you will need a voltage converter. Outlets in Singapore generally accept one type of plug, having two parallel flat pins with ground pin. If your appliances plug has a different shape, you may need a plug adapter.

Singapore plug adapters: the grounded plug adapter WA-7 and the ungrounded plug adapter #5. These are the recommended wall outlet plug adapters for Singapore.

Useful Contact Information

Emergency

Police	999	Flight Info	800 542 4422
Fire Brigade	995	Tourist Hotline	800 736 2000
Ambulance	995	Directory	100

Dial a Cab

General Hotline	(65) 6342 5222	TIBS & SMRT	(65) 6555 8888
Comfort & City	(65) 6552 1111	Premier	(65) 6363 6888
Trans-Cab	(65) 6555 3333	Prime Taxi	(65) 6778 0808

Credit Cards

AMEX	1800 295 0500	Diners Club	6416 0900
JCB	(65) 6734 0096	Visa	800 448 1250
Master	800 110 0113		

Conference Registration

- 4 August 2019 (Sunday) 1600 - 1800 at Mandarin Meeting Suite 804 (Level 8), Main Tower
- 5 - 7 August 2019 (Monday to Wednesday) 0800 - 1700 at Mandarin Ballroom Foyer (Level 6), Main Tower

All participants are expected to register and collect their conference package prior to attending the conference. A name tag will be provided upon registration and will serve as the official pass to sessions, coffee breaks, lunches and other official functions.

Conference Dinner

Date 5 August 2019 (Monday)
Time 1900 - 2200
Venue Mandarin Orchard Hotel, Mandarin Ballroom II and III, Level 6

A dinner ticket is required for admission to the Conference Dinner. Cocktail reception starts at 1900.

Daily Tea Reception & Lunch Buffet

Date	Reception	Venue
5 August (Monday)	Morning Tea Reception and Lunch	Mandarin Ballroom II and III
	Afternoon Tea Reception	Mandarin Meeting Foyer (Level 8, Main Tower) and Orchard Meeting Foyer (Level 6, Orchard Wing)
6 August (Tuesday)	All meals	Mandarin Ballroom II and III
7 August (Wednesday)	All meals	Mandarin Ballroom II and III

Conference Rooms and Floor Plans

The Conference will be using meeting suites at both the Main Tower and Orchard Wing of Mandarin Orchard Hotel.

Programme	Venue
Opening Session MAS Plenary Session ADB I Plenary Session	<ul style="list-style-type: none"> Mandarin Ballroom I, Level 6, Main Tower
Bi-Plenary Sessions	<ul style="list-style-type: none"> Mandarin Ballroom I, Level 6, Main Tower Grange Ballroom, Level 5, Main Tower
Special Sessions Parallel Sessions	<ul style="list-style-type: none"> Mandarin Ballroom I, Level 6, Main Tower Mandarin Meeting Suites 801- 805, Level 8, Main Tower Orchard Meeting Suites 603 - 606, Level 6, Orchard Wing

Mandarin Ballrooms at Level 6

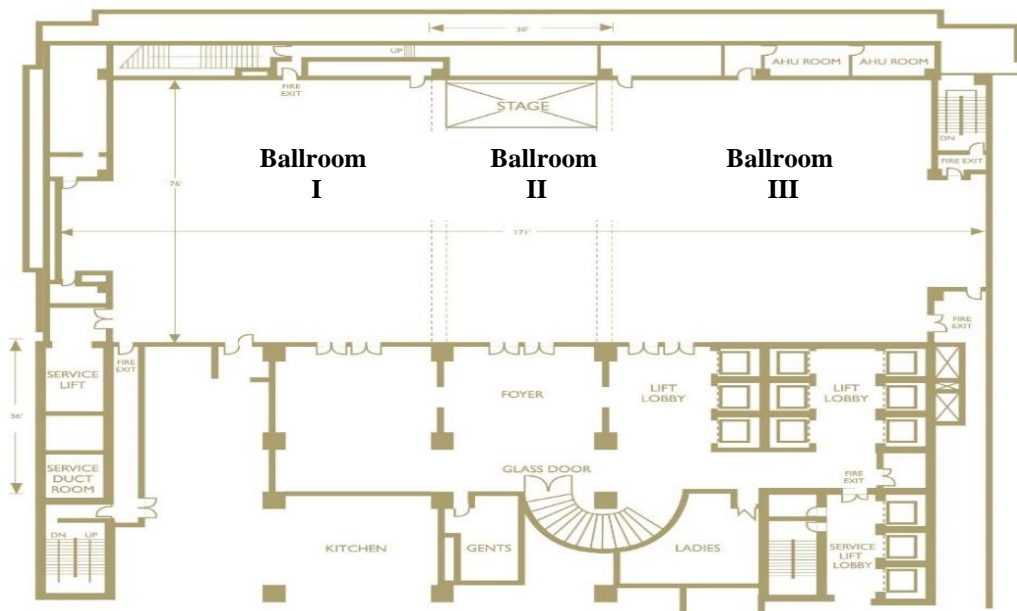

Mandarin Meeting Suites 801-805 at Level 8, Main Tower

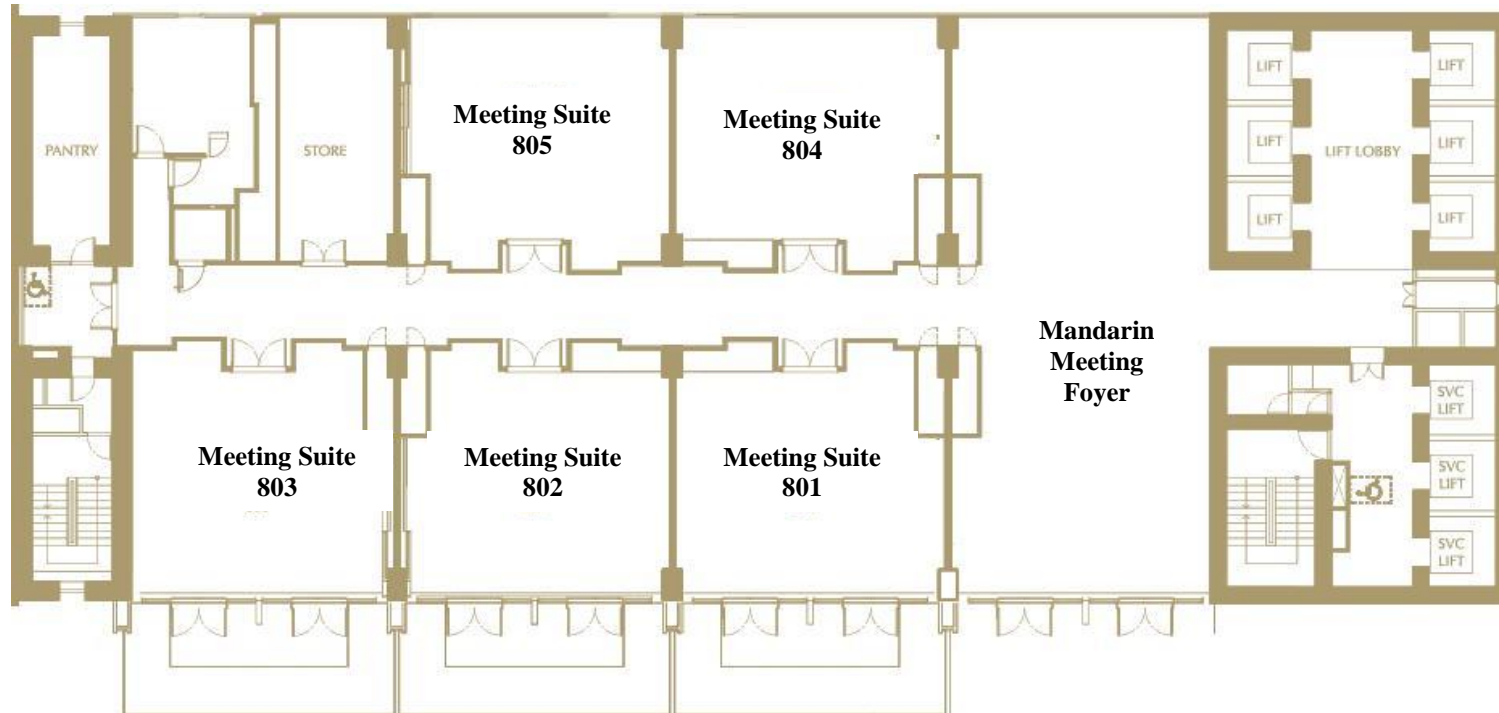

Orchard Meeting Suites 603 -606, Level 6, Orchard Wing



Uploading of Presentation – Service Station and Hours

Paper presenters are to upload PowerPoint slides to the laptops provided in the meeting rooms 10 minutes before their scheduled presentations. The laptops accept thumb drive.

Information & Assistance

Visit the Secretariat Desk located outside Mandarin Ballroom I Foyer at Level 6.

Internet Access

Wireless internet access is complimentary.

Travel & Tour

Tour information is available at the hotel reception.